

RECOMMENDED PCB LAYOUT

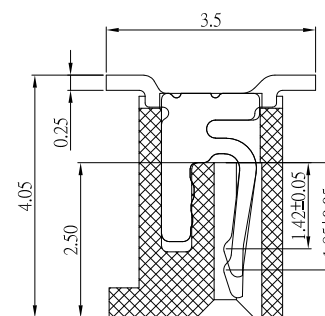

SECTION A-A

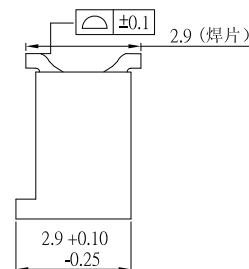
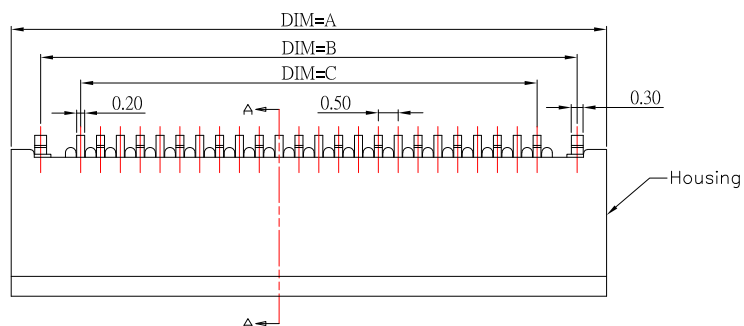
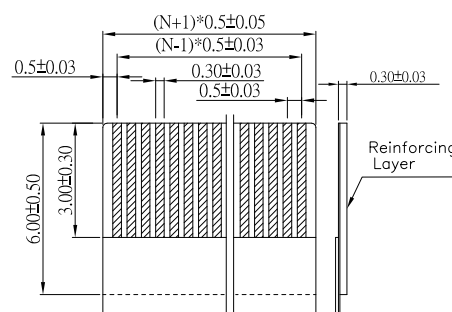
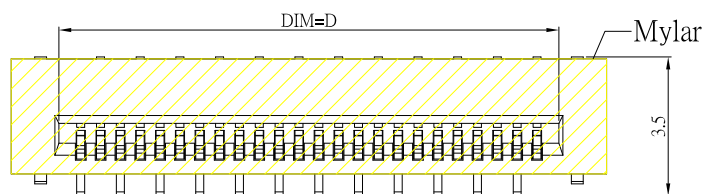

RECOMMENDED FFC/FPC DIM.

PIN数	DIM=A	DIM=B	DIM=C	DIM=D
48P	27.00	25.50	23.50	24.60
45P	25.50	24.00	22.00	23.10
44P	25.00	23.50	21.50	22.60
42P	24.00	22.50	20.50	21.60
40P	23.00	21.50	19.50	20.60
32P	19.00	17.50	15.50	16.60
30P	18.00	16.50	14.50	15.60
28P	17.00	15.50	13.50	14.60
26P	16.00	14.50	12.50	13.60
24P	15.00	13.50	11.50	12.60
22P	14.00	12.50	10.50	11.60
20P	13.00	11.50	9.50	10.60
18P	12.00	10.50	8.50	9.60
16P	11.00	9.50	7.50	8.60
14P	10.00	8.50	6.50	7.60
12P	9.00	7.50	5.50	6.60
10P	8.00	6.50	4.50	5.60
9P	7.50	6.00	4.00	5.10
8P	7.00	5.50	3.50	4.60
6P	6.00	4.50	2.50	3.60
4P	5.00	3.50	1.50	2.60

SPECIFICATIONS

Electrical Characteristics:

- 1.1 Voltage rating: 50V AC / DC
- 1.2 Current rating: 0.4A AC / DC
- 1.3 Temperature range: -25°C~+85°C
- 1.4 Withstand Voltage: 200V AC / Minute
- 1.5 Contact Resistance: 20mΩ MAX
- 1.6 Insulation resistance: 500MΩ MIN

Material:

- 1.1 Housing: LCP
- 1.2 Contact: Phosphor Bronze, Tin Plated over Nickel
- 1.3 Leg: Brass, Tin Plated over Nickel

13	新增插入深度	Jack	070224
12	更新俯视图焊脚长度	Jack	031124
11	更新PCB LAYOUT尺寸	Jack	051823
ITEM NO.	DESCRIPTION	DRAWN	DATE



TOLERANCE UNLESS OTHERWISE STATED:

Up to 5	±0.2
Above 5 ~ 15	±0.3
Above 15 ~ 30	±0.4
Above 30 ~ 50	±0.5
Angle	±0.3°

3RD. ANGEL'S

DRAWN BY:	DATE	MAT'L	TITLE	CONNECTOR
Jack Lu	07/02/24	FINISH	MODLE	FPC 直立式 SMT H:4.0mm
CHECKED BY:	DATE	SCALE	DWG NO.	FPC05S1-40xx-N-S304
Jacky Chen	07/02/24	1 : 1	PART NO.	FPC05S1-40xx-N-S304
APPROVED BY:	DATE	SHEET NO.	1 of 1	
Tony Kao	07/02/24			

SIZE	A4
VER	R12